

POWERLIGHT®

12Vdc IGNITER

PRODUCT SHEET

Features & Benefits

- **External heat sink eliminated for improved performance and reduced frequency of replacement due to overheating and arcing.**
- **Easy change to interrupted ignition to increase igniter life and save energy.**
- **Lightweight, single piece design is compatible with Beckett and other burners to reduce required inventory.**
- **Fully potted with improved epoxy to withstand thermal shock and protect electronic components; waterproof.**
- **Simplified wiring requirements and fewer wires for ease of installation.**

Product Description

Beckett's new PowerLight igniters offer improved performance and longer life. This igniter is easy to install and is designed as a universal replacement in Beckett and other manufacturer's burners.



5270005U -
Igniter Only

Functionality

- 20kV peak rating guarantees quick and efficient ignition
- Weighs less than 1 lb. versus an 8 lb. iron core transformer, making shipping and installation easier
- A vacuum encapsulation process, using epoxy, provides resistance to moisture, excellent heat dissipation and electrical insulation
- Case material is high-temperature thermoplastic that provides high impact strength, scratch resistance, impenetrable to oil and most chemicals
- Adapts to multiple baseplates - making it the most versatile unit on the market.
- Epoxy potting will not shrink or crack like tar-filled transformers

Available Igniters



5270001U -
Beckett AF/AFG

5270002U -
Beckett SF/SM,
CF500, CF800



5270003U -
Wayne MSR

5270004U -
Wayne EH/
EHASR



Beckett®

POWERLIGHT® 12Vdc IGNITER

Product Dimensions

Weight:
Less than 1 lb.

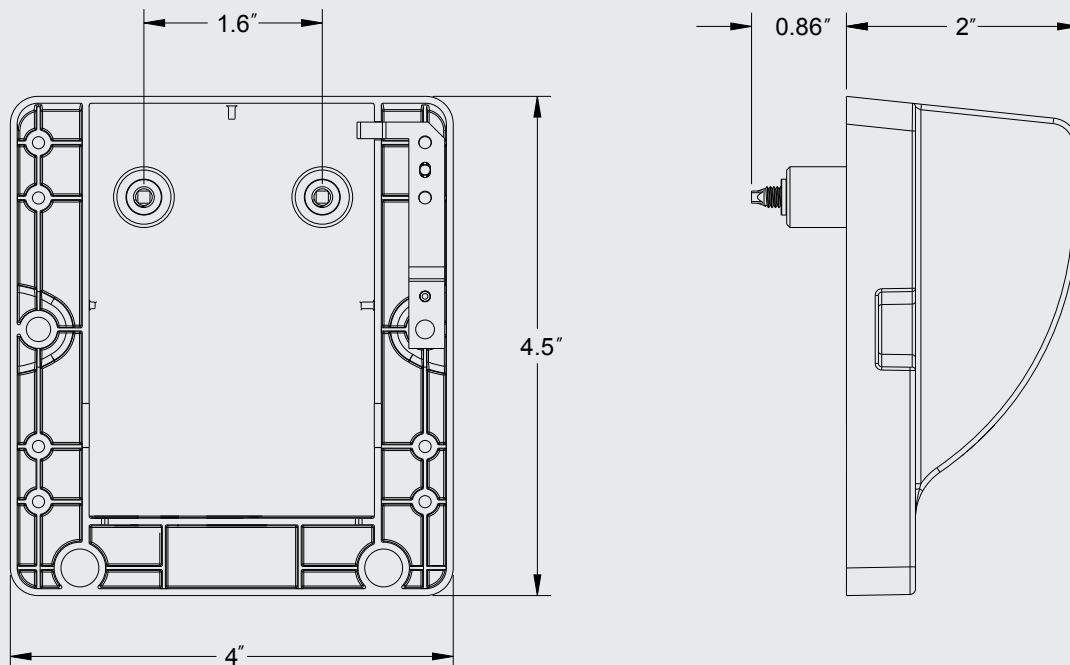

Ordering Information

| Igniter | Description | Replaces |
|----------|--------------------|----------|
| 5270001U | Beckett ADC 12 Vdc | 5218301U |
| 5270002U | Beckett SDC 12 Vdc | 5218303U |
| 5270003U | Wayne MSRDC | 5218305U |
| 5270004U | Wayne E | 5218307U |
| 5270005U | Igniter only | 5218309U |

Igniter Baseplate Kits

(includes 1 baseplate, hardware and instructions)

| Part Number | Description |
|-------------|-------------------|
| 51830U | Beckett A Housing |
| 51831U | Beckett S Housing |
| 51833U | Wayne E |
| 51829U | Wayne M |

Product Specifications

Input Voltage: 10.8 - 16 Vdc

Output Voltage: 20kV peak

Output Current: 25 mA RMS

Input Current: 2.5 A Maximum

Ambient Operating Temperature:
-40°F (-40°C) to 150°F (66°C)

Storage Temperature:
-40°F (-40°C) to 150°F (66°C)

Moisture: 5 to 95% Relative Humidity

USA: **R.W. Beckett Corporation**, 1-800-645-2876
Canada: **R.W. Beckett Canada Ltd**, 1-800-665-6972
www.beckettcorp.com Form No. 62245-004, R0

This document and all information contained herein are the sole property of the R.W. Beckett Corporation and cannot be reproduced or transmitted in whole or part without express written permission of the R.W. Beckett Corporation.

Beckett®