

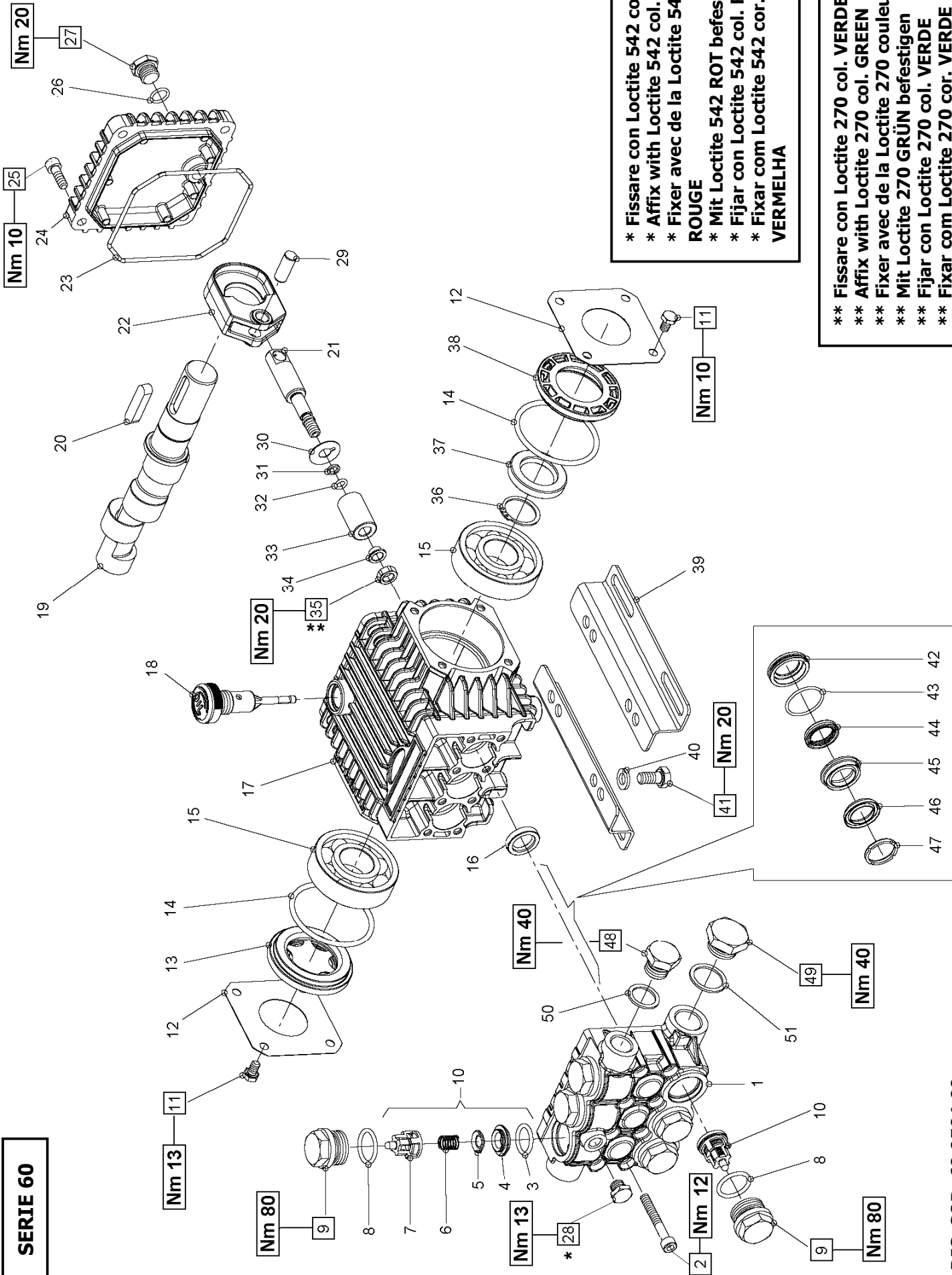

SERIE 60



* Fissare con Loctite 542 col. ROSSO
 * Affix with Loctite 542 col. RED
 * Fixer avec de la Loctite 542 couleur ROUGE
 * Mit Loctite 542 ROT befestigen
 * Fijar con Loctite 542 col. ROJO
 * Fixar com Loctite 542 cor. VERMELHA

** Fissare con Loctite 270 col. VERDE
 ** Affix with Loctite 270 col. GREEN
 ** Fixer avec de la Loctite 270 couleur VERT
 ** Mit Loctite 270 GRÜN befestigen
 ** Fijar con Loctite 270 col. VERDE
 ** Fixar com Loctite 270 cor. VERDE



**EL1707 - EL1708 - EL1510 - EL1513
UL1708 - UL1509 - UL1710 - UL1512
EH1708 - EH1710 - EH1711 - EH1713
UH1708 - UH1710 - UH1712 - UH1713**



PISTONE - PISTON Ø15		PISTONE - PISTON Ø18	
EL1707 - EL1708 UL1708 - UL1710 EH1708 - EH1710 EH1711 - EH1713 UH1708 - UH1710 UH1712 - UH1713		EL1510 - EL1513 UL1509 - UL1512	

POS	COD.	DESCRIZIONE - DESCRIPTION - KIT	NR
1	60.1200.41 60.1201.41	Testata pompa Ø 15 Testata pompa Ø 18	1 1
2	99.1950.00	Vite M6x45 UNI 5931	8
3	90.3841.00	OR Ø 17.13x2.62 (3068)	123
4	36.2003.66	Sede valvola	123
5	36.2001.76	Valvola	123
6	94.7376.00	Molla Ø 9.4x14.8 - INOX	123
7	36.2025.51	Guida valvola	123
8	90.3847.00	OR Ø 20.24x2.62 90 Sh. (3081)	6
9	98.2214.00	Tappo valvola M24x1.5	6
10	36.7115.01	Gruppo valvola aspiraz./mandata	123
11	99.1807.00	Vite M6x10 UNI 5739	8
12	50.1500.74	Coperchio laterale carter	2
13	44.2118.01	Distanziale con indicatore	1
14	90.4097.00	OR Ø 55.56x3.53 (159)	2

KIT RICAMBI - SPARE KITS

KIT Nr.	KIT 83	KIT 123	PISTONE - PISTON Ø15			PISTONE - PISTON Ø18				
			KIT 196	KIT 198	KIT 200	KIT 226	KIT 197	KIT 199	KIT 225	KIT 227
Posizioni include Positions included	16	3-4 5-6 7 (10)	44-46 47	45	42-43	42-43 44-45 46-47	44-46 47	45	42-43	42-43 44-45 46-47
Nr. Pcs.	3	6	3	3	3	1	3	3	3	1

POS	COD.	DESCRIZIONE - DESCRIPTION - KIT	NR	POS	COD.	DESCRIZIONE - DESCRIPTION - KIT	NR
15	91.8328.00	Cuscinetto a sfere 6305	2	34	44.2115.70	Rosetta con collare Ø 8	3
16	90.1565.00	Anello rad. Ø 15x24x5	83	35	92.2216.00	Dado M8x13x5	3
17	60.0100.22	Carter pompa	1	36	90.0635.00	Anello seeger Ø 25 UNI 7435	1
18	98.2103.00	Tappo carico olio G 3/8"	1	37	90.1634.00	Anello rad. Ø 25x42x7	1
	60.0202.65	Albero ecc. - UH1708	1	38	50.2115.54	Distanziale	1
	60.0204.65	Albero ecc. - EH1708-UH1710	1	39	50.2000.74	Piedini pompa	2
	60.0207.65	Albero ecc. - UL1509-EH1710-UH1712	1	40	96.7016.00	Rosetta Ø 8,4 UNI 1751	4
19	60.0209.65	Albero ecc. - EH1711-UH1713	1	41	99.3037.00	Vite M8x16 UNI 5739	4
	60.0212.65	Albero ecc. - EL1707-EL1510-UL1708 UL1512-EH1713	1	42	60.0800.70 60.0801.70	Anello di fondo Ø 15 Anello di fondo Ø 18	200-226 225-227
	60.0217.65	Albero ecc. - EL1708-EL1513-UL1710	1	43	90.3604.00	OR Ø 25.12x1.78 (2100) 200-225-226-227	3
20	91.4892.00	Linguetta 8x7x35 UNI 6604	1	44	90.2608.00 90.2650.00	Anello ten. alt. Ø 15x22x5 LP Anello ten. alt. Ø 18x24x5 LP	196-226 197-227
21	60.0500.66	Guida pistone	3	45	60.2160.70 60.2161.70	Anello intermedio Ø 15 Anello intermedio Ø 18	198-226 199-227
22	60.0300.22	Biella	3	46	90.2620.00 90.2661.00	Anello ten. alt. Ø 15x25x5/3.1 HP Anello ten. alt. Ø 18x26x5/3 HP	196-226 197-227
23	90.3918.00	OR Ø 94.92x2.62 (3375)	1	47	51.1000.51 51.1001.51	Anello di testa Ø 15 Anello di testa Ø 18	196-226 197-227
24	60.1600.22	Coperchio posteriore carter	1	48	98.2100.00	Tappo G 3/8"x13	1
25	99.1867.00	Vite M6x18 UNI 5931	4	49	98.2176.00	Tappo G 1/2"x10	1
26	90.3585.00	OR Ø 10.82x1.78 (2043)	1	50	96.7380.00	Rosetta Ø 17.5x23x1.5	1
27	98.2041.00	Tappo G 1/4"x9	1	51	96.7514.00	Rosetta Ø 21.5x27x1.5	1
28	98.1966.00	Tappo G 1/8"x8	1				
29	97.7333.00	Spinotto Ø 9x24.5	3				
30	96.7070.00	Rosetta Ø 9x23x0.5	3				
31	90.5022.00	Anello antiest. Ø 6.2x9x1.5	3				
32	90.3573.00	OR Ø 5.28x1.78 (2021)	3				
33	60.0400.09 60.0401.09	Pistone Ø 15x30 Pistone Ø 18x30	3 3				