

BLAST-TEC PRO™

ROTATING TURBO NOZZLE



The Blast-Tec Pro was designed specifically for high-pressure, high-impact vehicle wash applications including wheel blasters, undercarriage wash, rinsing, and high-pressure cleaning.

GREATER IMPACT – Blasts a 0° straight water stream at up to 1,000 PSI (70 bar), while rotating at an optimal speed to provide a 24° or 30° cone of coverage.

LESS WATER – Greater impingement allows you to use a smaller Blast-Tec Pro nozzle size while getting the same impact as nozzles with higher GPM flow rates.

HEAVY DUTY – Corrosion resistant stainless-steel housing and precision machined tungsten carbide wear surfaces offer long life and smooth operation. Blast-Tec Pro is now equipped with stainless-steel inlets, thicker cans, radial seal, and an upgraded rotor.

LONG LASTING – Tested to 1000 hours and designed to outlast competitor nozzles, minimal number of components reduces complexity for better reliability.



BLAST-TEC PRO™

NOZZLES & ACCESSORIES

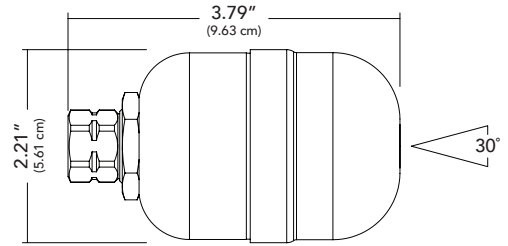
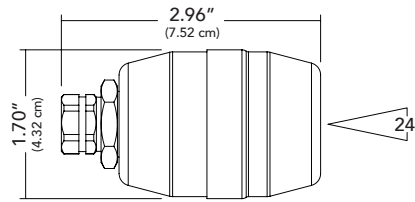

NOZZLE ORDER GUIDE

NOZZLE NUMBER	FLOW RATE (@1000 PSI) (69 bar)	BLAST-TEC PRO 324 24° ANGLE		BLAST-TEC PRO 430 30° ANGLE	
		1/4" BSPP INLET	1/4" NPT INLET	1/4" BSPP INLET	1/4" NPT INLET
2.0	1.00 GPM (3.8 LPM)	1001106	1001600	1001631	1001620
3.0	1.50 GPM (5.7 LPM)	1001107	1001601	1001632	1001621
3.5	1.75 GPM (6.6 LPM)	1001108	1001602	1001633	1001622
4.0	2.00 GPM (7.6 LPM)	1001109	1001603	1001634	1001623
4.5	2.25 GPM (8.5 LPM)	1001110	1001604	1001635	1001624
5.0	2.50 GPM (9.5 LPM)	1001111	1001605	1001636	1001625
5.5	2.75 GPM (10.4 LPM)	1001112	1001606	1001637	1001626
6.0	3.00 GPM (11.4 LPM)	1001113	1001607	1001638	1001627

ACCESSORIES

1/4" BSPP X 1/4" NPT KNUCKLE BALL JOINT ADAPTER

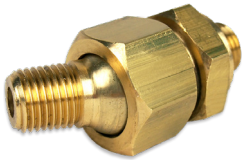

The Knuckle Ball Joint Adapter gives you the flexibility to point your nozzles directly at problem areas such as mirrors, license plates, louvers, etc. Adjustable ball easily swivels for custom nozzle positioning, adding up to 20 degrees actuation.

PART NUMBER

1001755

1/4" BSPP X 1/4" NPT ADAPTER

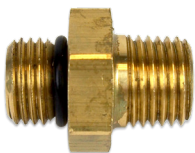

PART NUMBER

3000572

1/4" BSPP X 1/8" NPT ADAPTER

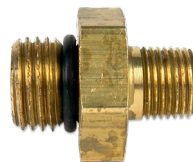

PART NUMBER

3000581

1/4" MBSP X 3/8" FNPT ADAPTER

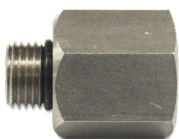

PART NUMBER

3000988

10 PACK OF DOME INLET SCREENS



PART NUMBER

1002883

BLAST-TEC PRO™ RETROFIT KITS

COLEMAN WATER WIZARD RETROFIT KIT



Coleman Water Wizard Nozzle Retrofit kits use up to 47% less water* than the factory standard nozzles. Kit includes nozzles for rockers, top and side oscillators. (Kit may require additional parts to be purchased from Coleman Hanna.)

KIT INCLUDES	PART #
(14) 2.0 Blast-Tec Pro 324 Nozzles (P/N 1001106), (10) 3.5 Blast-Tec Pro 324 Nozzles (P/N 1001108), and (24) 1/4" BSPP x 1/4" NPT Brass Adapters (P/N 3000572)	1001394

SONNY'S SPINNER/PENDULUM NOZZLE RETROFIT KIT

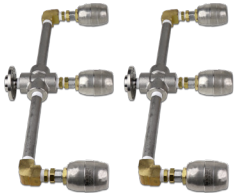

The Sonny's Spinner/Pendulum Nozzle Retrofit Kit can use up to 40% less water.* Replaces (10) factory-standard nozzles with (6) powerful Blast-Tec Pro nozzles. Eliminates troublesome spinner mechanism, reducing maintenance. Kit includes driver's and passenger's side.

KIT INCLUDES	PART #
(6) 4.0 Blast-Tec Pro 324 Nozzles (P/N 1001109), (6) 1/4" BSPP x NPT Brass Adapters (P/N 3000572), and (2) Spinner Eliminator Adapter (P/N 3000959)	1001448

SONNY'S OMNI I SIDE/WHEEL BLASTER NOZZLE RETROFIT KIT



The Sonny's OMNI I Side/Wheel Blaster can Nozzle Retrofit Kit can use up to 45% less water*. Replaces 20 factory-standard nozzles with 6 powerful Blast-Tec Pro Rotating Turbo Nozzles. Kit is designed for single nozzle manifold, includes both driver's and passenger's side. Order two kits for dual manifold.

KIT INCLUDES	PART #
(6) 4.0 Blast-Tec Pro 324 Nozzles (P/N 1001109), (6) 1/4" BSPP x NPT Brass Adapters (P/N 3000572), (6) 1/4" NPT Brass Street Elbow (P/N 3000670), and (16) 1/4" NPT Brass Hex Socket Plug (P/N 3000094)	1001441

SONNY'S OMNI I TOP/BUMPER BLASTER NOZZLE RETROFIT KIT



The Sonny's OMNI I Top/Bumper Blaster can Nozzle Retrofit Kit use up to 27% less water.* Replaces 10 factory-standard nozzles with 4 powerful Blast-Tec Pro Rotating Turbo Nozzles. Kit designed for single nozzle manifold. Order two kits for dual manifold.

KIT INCLUDES	PART #
(4) 4.0 Blast-Tec Pro 324 Nozzles (P/N 1001109), (4) 1/4" BSPP x NPT Brass Adapters (P/N 3000572), (4) 1/4" NPT Brass Street Elbow (P/N 3000670), and (7) 1/4" NPT Brass Hex Socket Plug (P/N 3000094)	1001447

MACNEIL MAGNUM WHEEL BLASTER NOZZLE RETROFIT KITS



MacNeil Magnum Kits can use up to 10% less water* than legacy factory-standard nozzles. (Blast-Tec Pro Nozzles are now factory-standard.) Kits include nozzles for both driver's and passenger's side.

KIT	KIT INCLUDES	PART #
MacNeil Magnum 300	(6) 3.5 Blast-Tec Pro 324 Nozzles (P/N1001108), (6) 1/4" BSPP x 1/4 NPT Brass Adapter (P/N 3000572)	1001443
MacNeil Magnum 600	(12) 3.5 Blast-Tec Pro 324 Nozzles (P/N1001108), (12) 1/4" BSPP x 1/4 NPT Brass Adapter (P/N 3000572)	1001444
MacNeil Magnum 900	(18) 3.5 Blast-Tec Pro 324 Nozzles (P/N1001108), (18) 1/4" BSPP x 1/4 NPT Brass Adapter (P/N 3000572)	1001445

*Water savings calculations are based on 1000 PSI (69 bar) and minimum required nozzle sizes. Actual water savings may vary based on unique application.

BLAST-TEC PRO™

ROTATING TURBO NOZZLE

SPECIFICATIONS				
Minimum Inlet Pressure	800 PSI (55 bar)		Housing Material	Stainless Steel
Maximum Inlet Pressure	1,200 PSI (83 bar)		Weight: Blast-Tec Pro 324	0.50 lbs (.23 kg)
Optimal Operating Distance	12" - 32" (31 - 82 cm)		Weight: Blast-Tec Pro 430	0.95 lbs (.43 kg)
Maximum Temperature	+120°F (+49°C)		Water Filtration (Recommended)	100 Micron

VEHICLE COVERAGE/NOZZLE SPACING/DISTANCE FROM SUBSTRATE

24° Cone

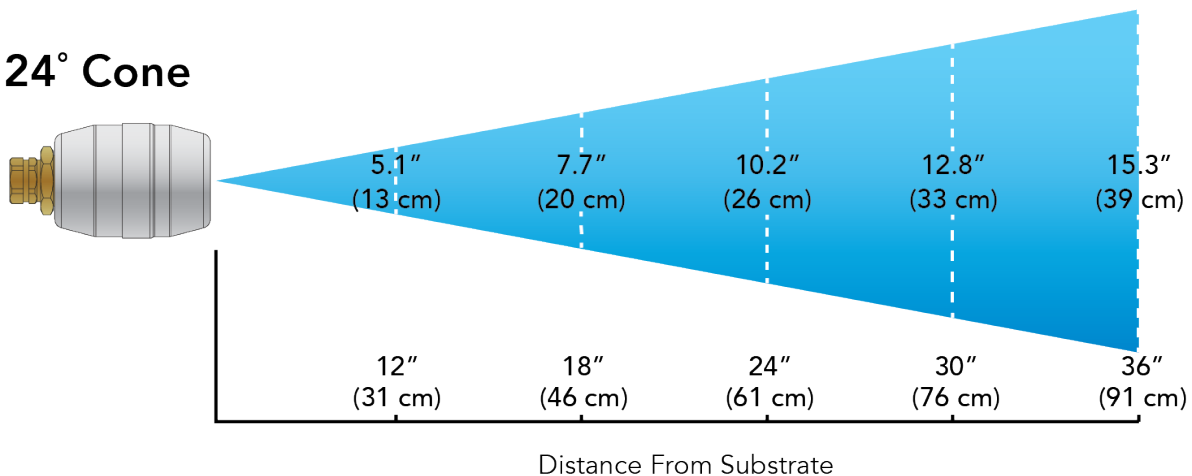

30° Cone

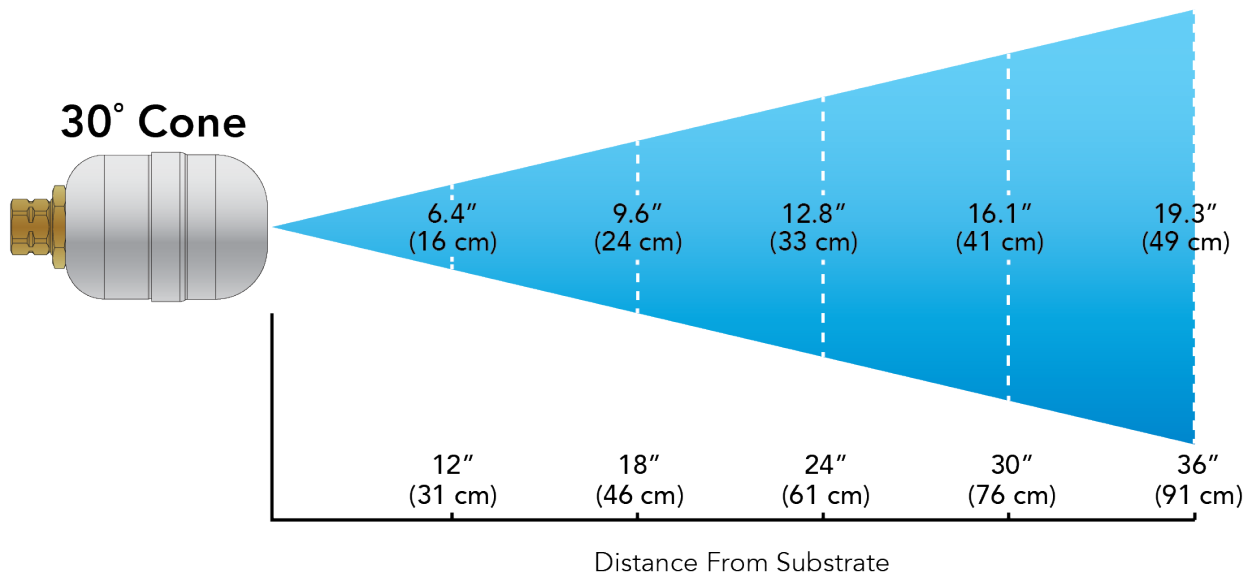

WARNING! The closer to the substrate, the higher the impact of the nozzle. Positioning the nozzle too close to the substrate may cause damage. If reduced impingement is required, use a nozzle with less flow. Ex. If using a # 4.0 has too high impact, switch to a smaller nozzle such as a # 3.0 or # 2.0. **DO NOT REDUCE WATER PRESSURE BELOW 800 PSI (55 bar) AS A WAY TO REDUCE IMPINGEMENT.**

